



HOME & ABROAD RENTALS LTD
LETTING & MANAGEMENT



Mole End Shrublands Avenue

, Berkhamsted, HP4 3JH

£3,200 PCM

A spacious four bedroom family home discreetly located in a quiet location off Shrublands Avenue, very close to Berkhamsted town centre, schools and shops. Newly decorated throughout. The property benefits from an enclosed garden, garage and off street parking. Gas Central Heating. Pets - cat only. Available 12th March.

UNFURNISHED

Accommodation comprises: Entrance hall, large dual aspect living room, dining room, reception room, fitted kitchen, utility room, cloakroom. Master bedroom with fitted wardrobes and en-suite shower room, guest bedroom, two further double bedrooms, family bathroom.

- Available 12th March
- Berkhamsted
- Unfurnished
- Detached House
- Gas Central Heating
- Council tax band G
- Garden
- Driveway and garage

Viewing

Please contact us on 01442 872885 if you wish to arrange a viewing appointment for this property or require further information.



Floor Plan

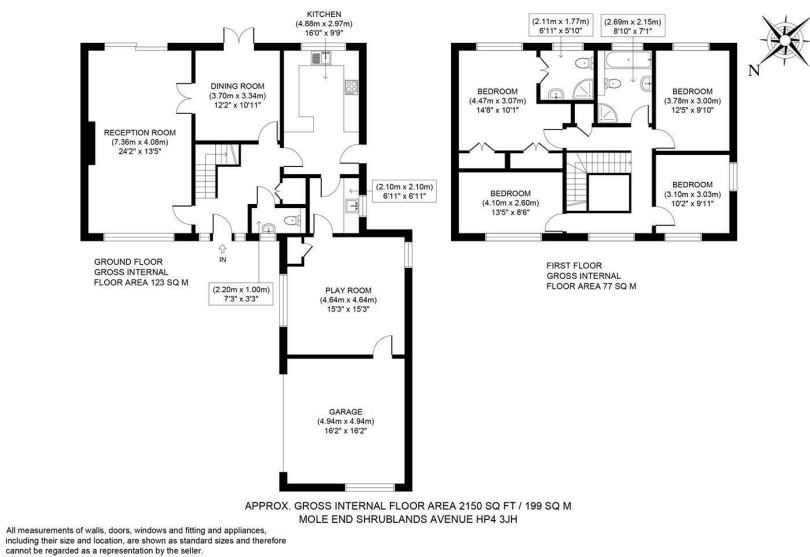

Area Map



Energy Efficiency Graph

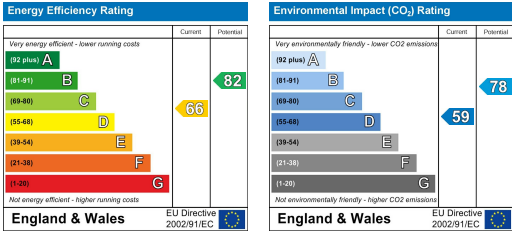

These particulars, whilst believed to be accurate are set out as a general outline only for guidance and do not constitute any part of an offer or contract. Intending purchasers should not rely on them as statements of representation of fact, but must satisfy themselves by inspection or otherwise as to their accuracy. No person in this firms employment has the authority to make or give any representation or warranty in respect of the property.